

# **Driving Directions** to Martha Morehouse Medical Plaza

**U.S. News & World Report  
Best Hospital 2012**

## **From the North** (Sandusky, Delaware and Cleveland)

Take any major highway to I-270  
Take I-270 to SR 315 south  
Take SR 315 south to the Lane Avenue exit.  
Turn right onto Lane Avenue.  
Take Lane Avenue to Kenny Road.  
Turn left onto Kenny Road.  
Martha Morehouse Medical Plaza will be on your left.

## **From the South** (Circleville, Chillicothe and Cincinnati)

Take any major highway to I-71 north  
Take I-71 north to SR 315 north  
Take SR 315 north to the Lane Avenue exit.  
Turn left onto Lane Avenue.  
Take Lane Avenue to Kenny Road.  
Turn left onto Kenny Road.  
Martha Morehouse Medical Plaza will be on your left.

## **From the East** (Newark, Zanesville and Pittsburgh)

Take any major highway to I-70 west  
Take I-70 west to SR 315 north  
Take SR 315 north to the Lane Avenue exit.  
Turn left onto Lane Avenue.  
Take Lane Avenue to Kenny Road.  
Turn left onto Kenny Road.  
Martha Morehouse Medical Plaza will be on your left.

## **From the West** (Springfield, Dayton and Indianapolis)

Take any major highway to I-70 east  
Take I-70 east to SR 315 north  
Take SR 315 north to the Lane Avenue exit.  
Turn left onto Lane Avenue.  
Take Lane Avenue to Kenny Road.  
Turn left onto Kenny Road.  
Martha Morehouse Medical Plaza will be on your left.

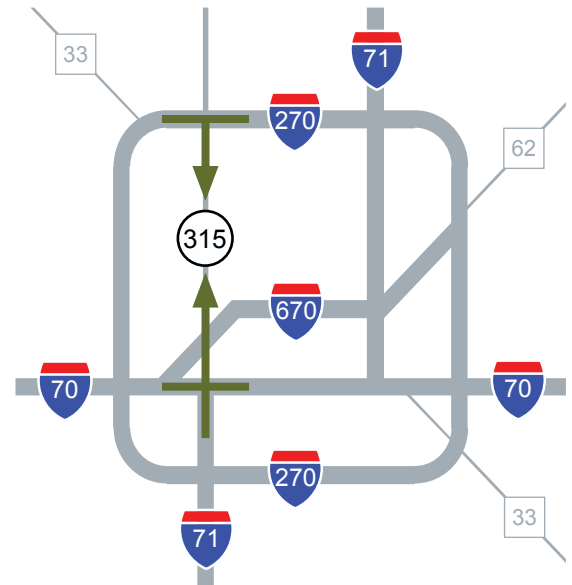

↑ North  
Not to Scale

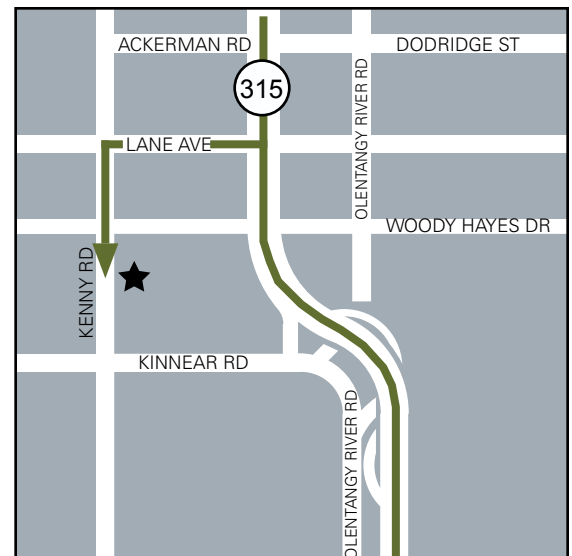

★ **Martha Morehouse Medical Plaza**  
2050 Kenny Road  
Columbus, OH 43221  
614-293-5123

[medicalcenter.osu.edu](http://medicalcenter.osu.edu)



Smoking and the use of tobacco products are not permitted inside or outside of any of Ohio State's Wexner Medical Center buildings



**Wexner  
Medical  
Center**

June 18, 2012

# ***Finding Your Way*** Martha Morehouse Medical Plaza

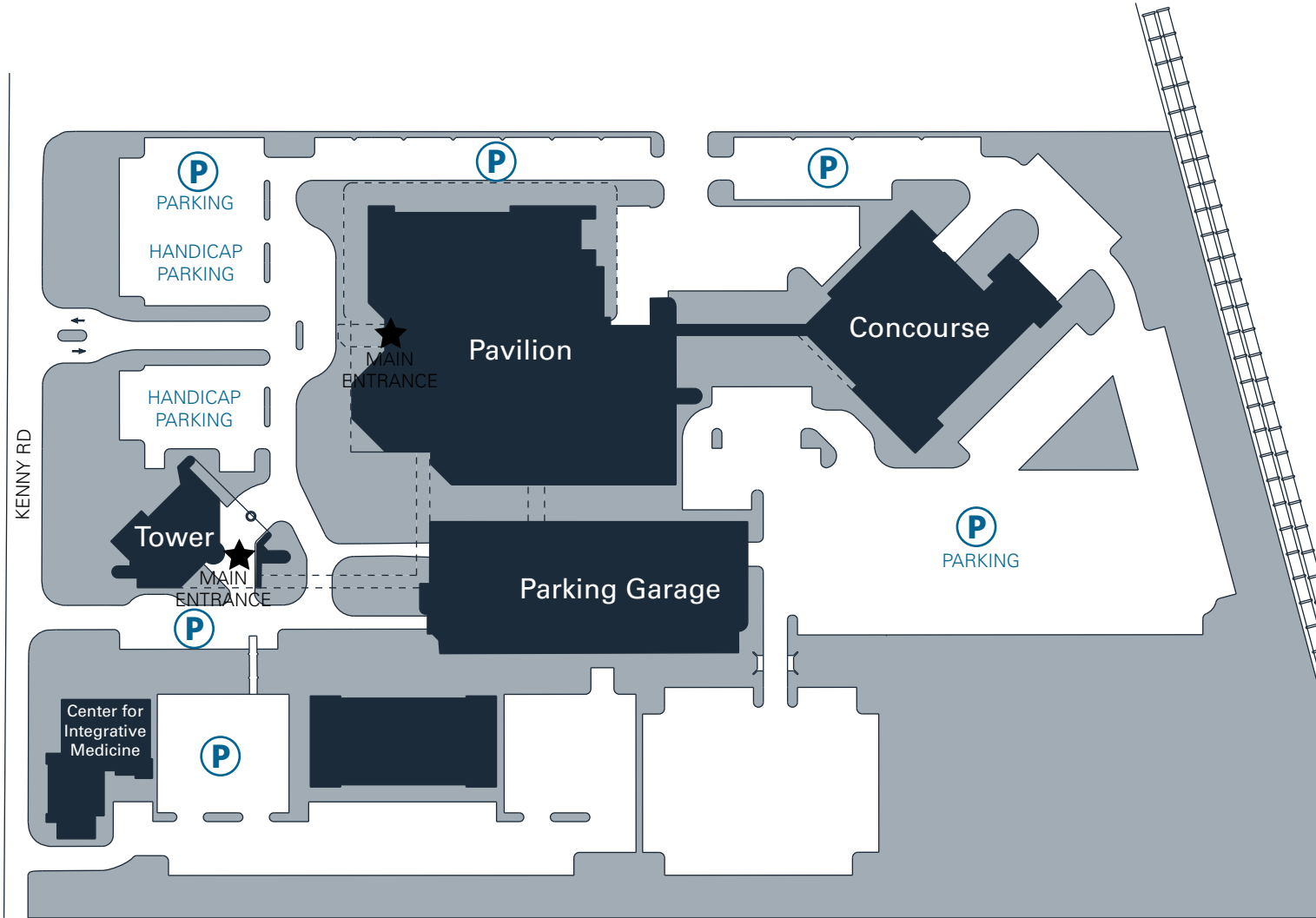

↑ North  
Not to Scale

★ Valet Service is available at these locations

## **Martha Morehouse Medical Plaza**

2050 Kenny Road  
Columbus, OH 43221  
614-293-5123

[medicalcenter.osu.edu](http://medicalcenter.osu.edu)



**Wexner  
Medical  
Center**

# ***Services by Building***

## Martha Morehouse Medical Plaza

### **Martha Morehouse Tower**

JamesCare Dermatologic Oncology/MOHS Surgery  
JamesCare Gastroenterologic Oncology  
JamesCare Infusion Center  
JamesCare Medical Information Management  
JamesCare Physician Center  
JamesCare Thoracic Oncology  
Lab  
Maternal Fetal Medicine  
OB Ultrasound  
Perinatal Consultants  
Registration

### **Martha Morehouse Pavilion**

A.T. Ohio  
Assistive Technology Center  
Auditorium  
Bariatric Surgery  
Center for Wellness & Prevention  
Heart Center  
Internal Medicine  
Lab  
Lung, Sleep and Allergy Center  
Movement Analysis & Performance Research Lab/Gym  
Outpatient Rehabilitation Services  
Perioperative Assessment Center (OPAC)  
Physical Medicine and Rehabilitation  
Pool  
Pulmonary Clinical Trials  
Pulmonary Diagnostics Lab  
Radiology/Imaging  
Registration  
Sports Medicine  
TBI Network

### **Martha Morehouse Concourse**

Wound Care Center  
Wright Center of Innovation



Wexner  
Medical  
Center